



# BRIDGE OF DON ACADEMY

*Be Caring Be Honest Be Respectful Be Your Best*

Braehead Way • Bridge of Don • Aberdeen • AB22 8RR

Tel 01224 707583

Web: [www.bridgeofdon.aberdeen.sch.uk](http://www.bridgeofdon.aberdeen.sch.uk)

E-mail: [bridgeofdon@aberdeencity.gov.uk](mailto:bridgeofdon@aberdeencity.gov.uk)

**Head Teacher: Daphne McWilliam**



25 June 2021

Dear Parent/Carer

## **Head Teacher's Update – 25 June 2021**

I write to update you on the following:

- School Dates
- Staffing Changes from August 2021
- Information for new S1 pupils
- A Reminder of Mitigations in Place from August 2021
- Expectations: Our school Values
- School Uniform
- Senior Phase Pupils and Study classes
- Summer of Play
- Lateral Flow Testing including over the summer period
- Pathway Planning

### **School Dates**

Monday 16 August - In-Service Day

Tuesday 17 August - First Day of Term for all

### **Staffing Changes from August 2021**

There are several staffing changes which we would like to intimate.

### **Staff Farewells**

Our best wishes go to Mrs Gwyneth McWilliam and Miss Sheena Anderson on their retirement from Bridge of Don Academy. Together they have dedicated over 70 years to teaching to our young people. Many young people who have attended Bridge of Don Academy – including some of our parents – have many reasons to be grateful for the skills, hard work and dedication of these two fine teachers and we wish them good health and happiness as they embark on this new phase of their lives. Both have been a great asset to the school and will be sorely missed by their friends and colleagues. We were not able to send them off in quite the normal way but hope to do that in the new term. However, presentations and speeches were made – outdoors - and fortunately, the sun shone!

Mrs Melody Mitchell will be leaving us to take up an English post at Ellon Academy. Miss Mitchell has 14 years of service at Bridge of Don Academy. We would like to thank her for her commitment to the school and wish her well in her new post.

Miss Ailsa Morton, who had been our probationer teacher in Home Economics, is taking up a post at The Robert Burns Academy in East Ayrshire.

### **New Staff**

We are very fortunate to be able to welcome a number of new staff in next session. Firstly, we have been allocated a number of probationers:

- Art & Design – Ms L Milne
- Computing Science – Mr J Duff
- Mathematics – Mr J Anthony

In addition to this we are awaiting confirmation of the appointments we have made for the following positions:

- Head of Braemar House (Guidance)
- Teacher of History
- Teacher of Science and Biology
- Teacher of Home Economics

### **New S1 Pupils**

We are looking forward to welcoming our new S1 pupils back to school. Almost all of them have had one visit and tour of the school so the building should be familiar to them. On Tuesday 17 August they should gather at the community/swimming pool entrance to the school – detailed on the map at the end of this letter. Please note that we ask parents/carers to drop off their children on Braehead Way and **not** to use either of the car parks as this causes considerable congestion. They will be met by members of the Senior Leadership Team and their Registration Teacher and then have an Assembly. They will be given their Accord Card and so can bring money to be put into their account and then purchase snacks and a meal at lunch.

Arrangements have been made this week to notify pupils of their class via their primary school. If they arrive knowing this it will speed up the process of getting them organised for the day but we will also have the information available on the day.

We will not be able to provide Senior Pupil guides for S1s as we have traditionally done because we are required to keep pupils separate from one another – an S1 – S3 bubble and an S4 – S6 bubble. However, teachers of each S1 class will direct them to their next class: we found last year that young people responded well to this and soon found their way round the school.

### **Mitigations in Place from August 2021**

As I intimated last week, we have been advised to start the new term with the current mitigations in place.

- Separate entrances for each year group – please note each year group will now change to use the door allocated to their new year group. See map at the end of this letter.
- Continued use of hand sanitising gel on entering school and on entering and leaving each class.
- The wearing of face coverings (unless exempt) for all young people and staff.
- The use of provided cleaning materials to clean desk and equipment under the direction of teachers.
- Staggered break and lunch times for S1 – S3 pupils and S4 – S6 pupils.

We will go over this with all pupils on day one as a reminder along with our expectations.

### **Expectations: Our School Values:**

*Be Caring - Be Respectful - Be Honest - Be Your Best*

Our 'BODA Bs' are the basis of all our work in school and what we expect of our entire school community: pupils and staff and, I would respectfully suggest, our parents and carers. The rules we have in place – all of which can be read in the School Prospectus – are there to keep young people safe and to ensure the good order within the school so that everyone can focus on what we are here to do – learn together.

### **Pupils Going Off School Grounds**

#### **Morning Break**

All young people must stay on school grounds for morning break. They should ensure that have their own Accord Card to purchase snacks in the canteen or take their own snack to school. There is no time at morning break for young people to be able to get to the shops and back and be on time for classes. In addition, we are responsible for young people and can only supervise the school canteen and patrol school grounds: we cannot patrol the community to ensure young people are safe. Although we do make spot checks on the shops on Braehead Way and will direct pupils back to school. Persistent offenders will be put on detention at morning break.

#### **Lunch Break**

##### **S1**

Young people in S1 are expected to stay on school grounds at lunch time unless they go home for lunch.

##### **S2 – S6**

Young people in S2 – S6 may leave school grounds to buy their lunch locally and we would expect them to be able to do this and return to class on time. Persistent lateness after lunch will be dealt with in the same way as lateness in the mornings.

We have a well-developed system for recording lateness and consequences for those who are persistently late. This includes keeping parent/carers informed. We will remind all young people about this system on our return to school in August.

The school grounds extend as far as the school playing fields but do not extend to the grounds of St Columba's Church. This area is out of bounds for all young people at break and lunch because we never know when there may be a funeral or service taking place which could be disturbed by the noise of young people congregating nearby.

School grounds do not include the skatepark or the playground beside the Alex Collie Centre.

## **School Uniform**

This [link](#) will take you to the page of the school website which has been updated and contains the details of Abstitch, our supplier of school ties and blazers. If you require any further information about the school uniform, please refer to my Head Teacher Update letter dated 11 June 2021. As you know pupils should wear PE kit on days when they have PE as changing rooms will not be in use. However, if S1 pupils do have PE on Tuesday 17 August activities will be appropriately chosen to enable them to participate.

The uniform for **all pupils** is now a shirt/blouse and tie with plain black trousers/skirt, jumpers and shoes. Blue tie for S1 to S4, red tie for S5 to S6. Some families did have leftover sweatshirts with the school logo on them and these were worn during session 2020-21 – which we accepted was practical. These are no longer part of school uniform.

Abstitch supply our school blazers which are required uniform for those returning to school for S5 and S6. Pupils from S1 to S4 can also purchase blazers from Abstitch as many already do.

## **Senior Phase Pupils and Study classes**

### **S4**

Young people must stay in their study class unless they have a scheduled remote meeting for a college course, or they are signing out of school to attend college in person.

### **S5**

As above and in addition young people can sign out of study to work on a subject where they need the practical equipment, for example, Music, Art & Design, Graphic Communication or Computing Science. This must be with the permission of the teacher in whose classroom they are working who will supervise them. They must ensure that for all other study periods they have sufficient work with them to complete.

### **S6**

As above and in addition young people may sign out to go home to study which

means leaving the school building – not going to the canteen. This is good preparation for life beyond school when young people will be expected to organise themselves to attend university or college lectures at different times in the day as well as scheduling personal study time.

If young people have study first period in the day they may opt to come into school and sign out to return home. Alternatively, they can let us know by telephoning the school office from home that this is their plan. If neither of these options is chosen parents/carers will get a Groupcall to informing them of their child's absence.

In all cases young people must sign out personally and if going home (S6 only) also sign out at the school office.

### **Summer of Play**

The Scottish Government have provided funding for local authorities to provide activities for young people who have been particularly impacted by the Pandemic. These activities are for young people living in Aberdeen City. The range of activities can be seen in the link I previously sent by Groupcall and are now available for booking.

[https://www.aberdeencity.gov.uk/services/summer-play?fbclid=IwAR0YfHotTI5IDbBj3Odvq9VrIEI0eq\\_krTKtdoY\\_LtkDTA0In9CiKqGoONU](https://www.aberdeencity.gov.uk/services/summer-play?fbclid=IwAR0YfHotTI5IDbBj3Odvq9VrIEI0eq_krTKtdoY_LtkDTA0In9CiKqGoONU)

### **Lateral Flow Testing Over Summer**

If you can, please keep testing through the summer period. Taking a Lateral Flow Device (LFD) test, ideally twice a week, helps with early detection of cases. LFD kits can be ordered via the NHS Inform website (details below) or collected from participating community pharmacies. If that is not possible, we would definitely encourage your child(ren) to resume testing just before the start of the new term. Remember, if they or you develop any of the known symptoms of COVID-19, you must arrange a PCR test as soon as possible. All the information you need on testing – both PCR and LFD – can be found on the NHS Inform website ([www.nhsinform.scot](http://www.nhsinform.scot)), just click on the red banner at the top of the page for all the latest COVID-19 information and advice.

If you require test kits to restart testing in the week prior to return to school please complete the online form below

S1-S3	<a href="https://forms.gle/K4Wj7MFcqykaNesK9">https://forms.gle/K4Wj7MFcqykaNesK9</a>
S4-S6	<a href="https://forms.gle/47MBrMQc7kvF9wH17">https://forms.gle/47MBrMQc7kvF9wH17</a>
NHS Consent	<a href="https://forms.gle/Gn85rMhKt25nNxY17">https://forms.gle/Gn85rMhKt25nNxY17</a>

In the summer holidays lateral flow tests can be accessed from NHS Grampian.  
<https://www.nhsgrampian.org/covid-19/covid-19-public-information/subpages/covid-19-community-testing/>

### **Pathway Planning**

### **Developing the Young Workforce (DYW) Opportunities**

The following have been posted this week:

- Business Administrator Apprenticeship
- Trainee Logistics Controller
- Modern Apprentice – CALA Homes
- Fancy a Career in Medicine?
- Modern Apprentice – Support Worker
- Graduate Apprentice – Petrofac
- MA in Early Learning and Childcare
- Retail Sales Assistant Apprenticeship
- Apprenticeship – Trainee Engineer

Young people also have access to My World of Work to find out more information about careers and pathways available to them.

Further DYW opportunities can be found using the following link - <https://bridgeofdon.aberdeen.sch.uk/wp/archives/8129>

In addition to the weekly opportunities, DYW also plan a yearly event which provides information for parents, carers, teachers, pupils & businesses.

### **Contact with School**

When e-mailing please provide your child's name and registration class and a note of the nature of the concern so it can be forwarded appropriately. For the final week of term, and until the appointment of a new Head of Braemar House is completed Mrs Napier, Mrs Marshall and Miss Smith will continue to support the young people they have been responsible for this year.

### **Pastoral Care**

Crathes House	Mrs Napier
Drum House	Miss Smith
Fyvie House	Mrs Marshall

### **Year Heads**

S1 and S2	Mr Haggarty
S3 and S4	Mrs Cruickshank
S5 and S6	Mr Jamieson

I hope that you all continue to be well and, as always, please do not hesitate to contact us if we can be of further support.

Yours sincerely

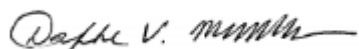

Mrs D McWilliam

Head Teacher



# BRIDGE OF DON ACADEMY

*Be Caring Be Honest Be Respectful Be Your Best*

Braehead Way • Bridge of Don • Aberdeen • AB22 8RR

Tel 01224 707583

Web: [www.bridgeofdon.aberdeen.sch.uk](http://www.bridgeofdon.aberdeen.sch.uk)

E-mail: [bridgeofdon@aberdeencity.gov.uk](mailto:bridgeofdon@aberdeencity.gov.uk)

Head Teacher: **Daphne McWilliam**

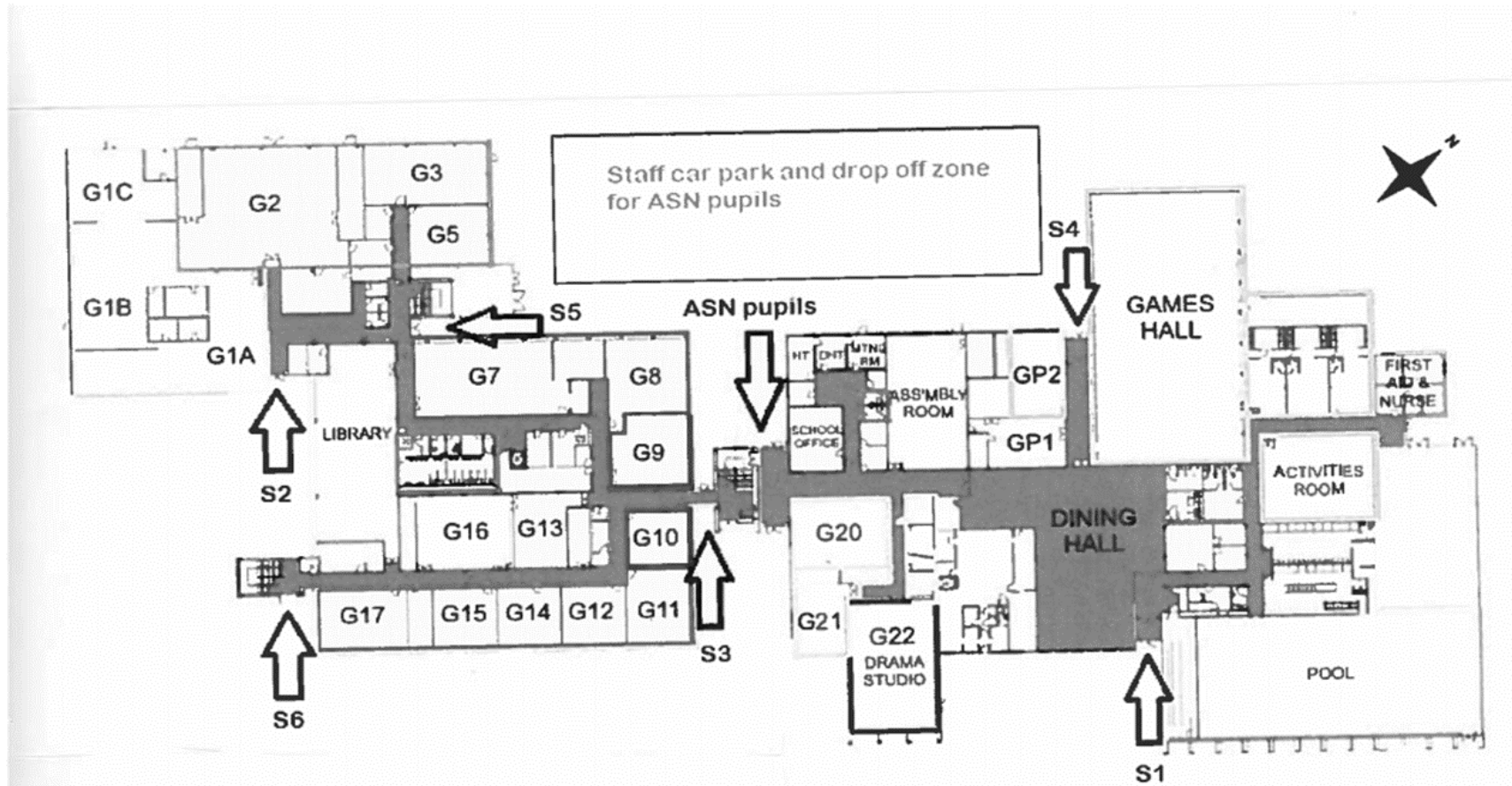

**BRIDGE OF DON  
ACADEMY**